

# PopUp Play™

## Car Assembly

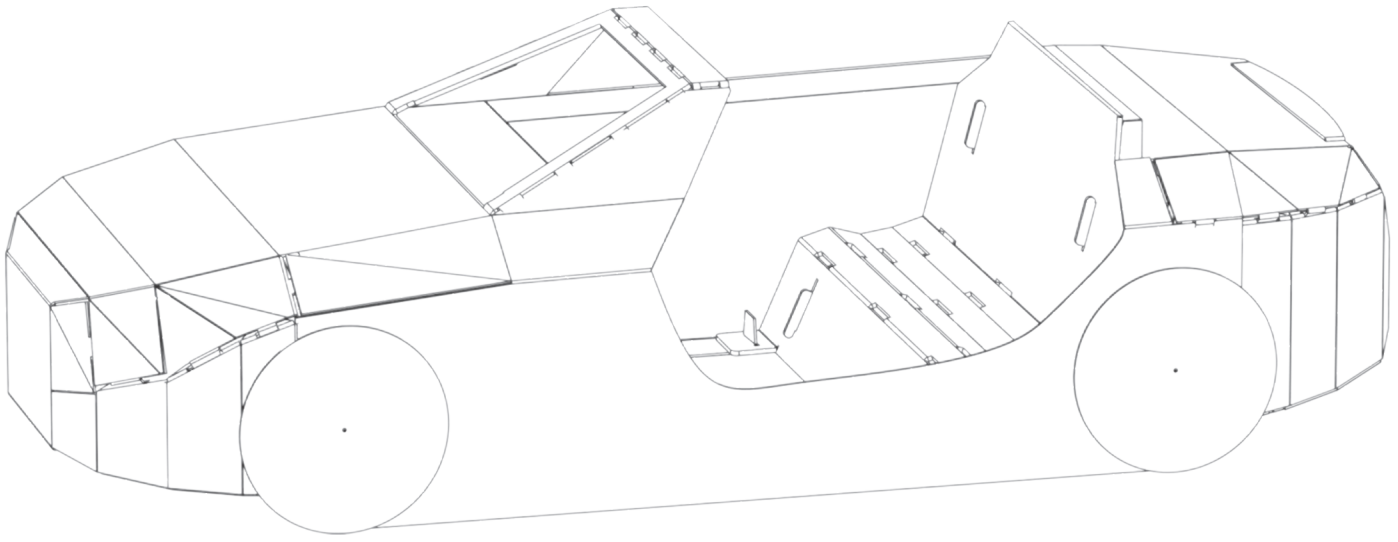

### Assembly Basics

#### FOLD CREASES BEFORE ASSEMBLY

Pre-crease all your pieces. Creases are shown with dashed lines on the car piece.

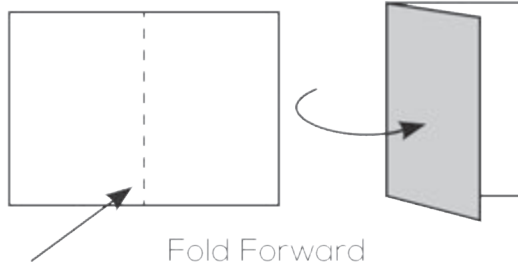

Fold Forward

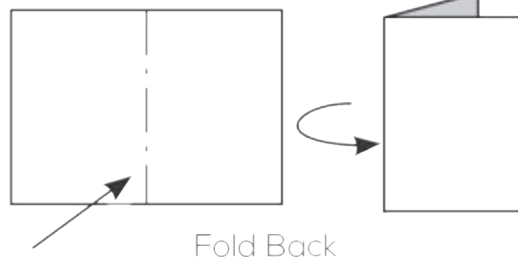

Fold Back

#### REMOVE SMALL PIECES

Each car will come with small pieces in the tab slots. You can identify them by the serrated edges. Poke out these pieces.

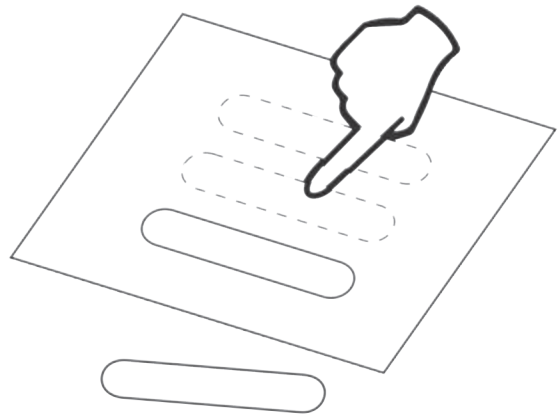

### Having trouble with assembly?

Watch the assembly video at [popupplaytoy.com/videos](http://popupplaytoy.com/videos)  
or call (512) 900-4247 and we can walk you through it.

WARNING: CHOKING HAZARD - small parts. Assemble with adult supervision.

The PopUp Play Car playhouse includes small parts and is not suitable for children under 3 years old. Keep away from wet or moist conditions as they will affect the structural integrity of the product.

This product is manufactured and sold by PopUp Play Inc. PopUp Play Inc. is using "Mercedes-Benz Financial Services", "Mercedes-Benz", the Mercedes-Benz star logo, and the design of the product with the permission of Mercedes-Benz Financial Services USA LLC. Mercedes-Benz Financial Services USA LLC is not affiliated with PopUp Play Inc.

# PopUp Play™

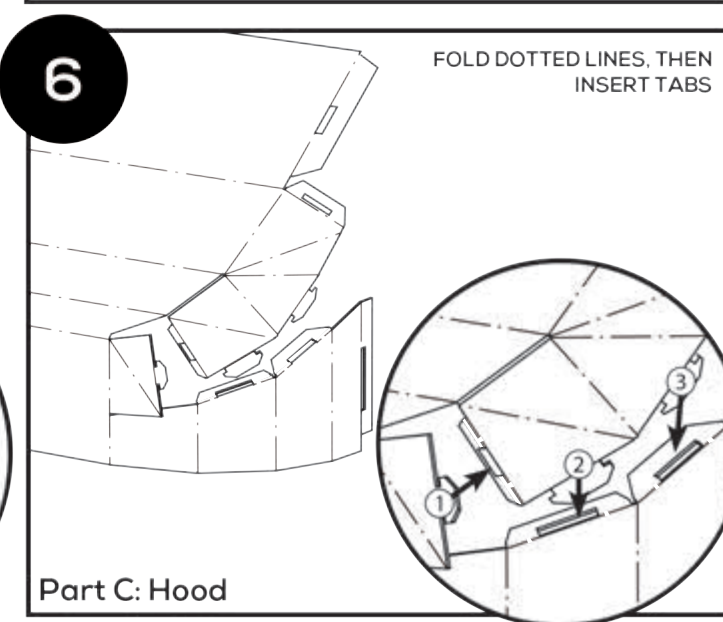
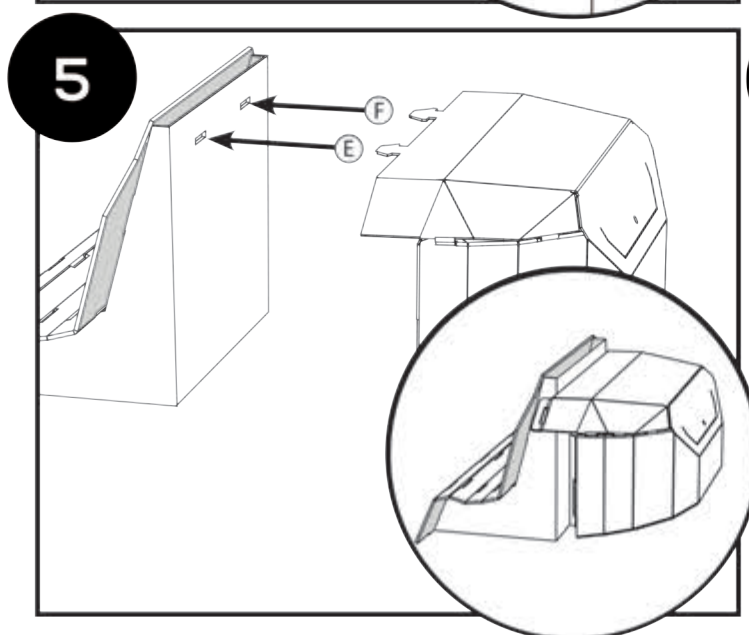
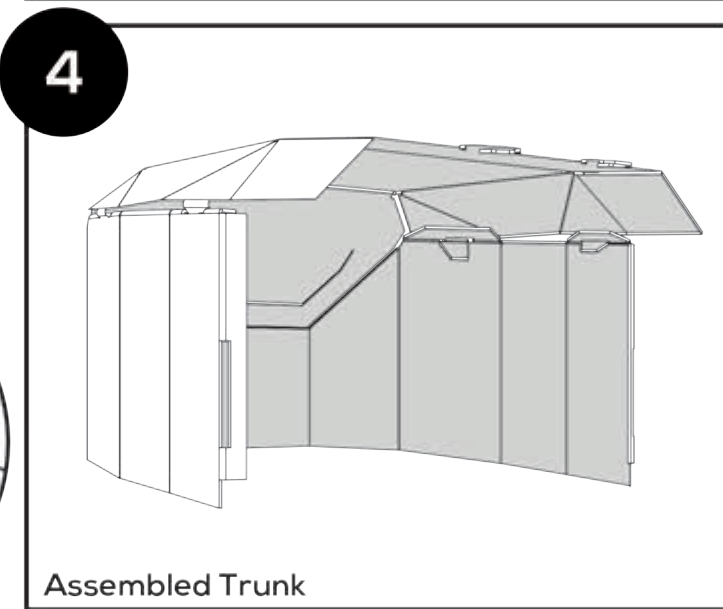
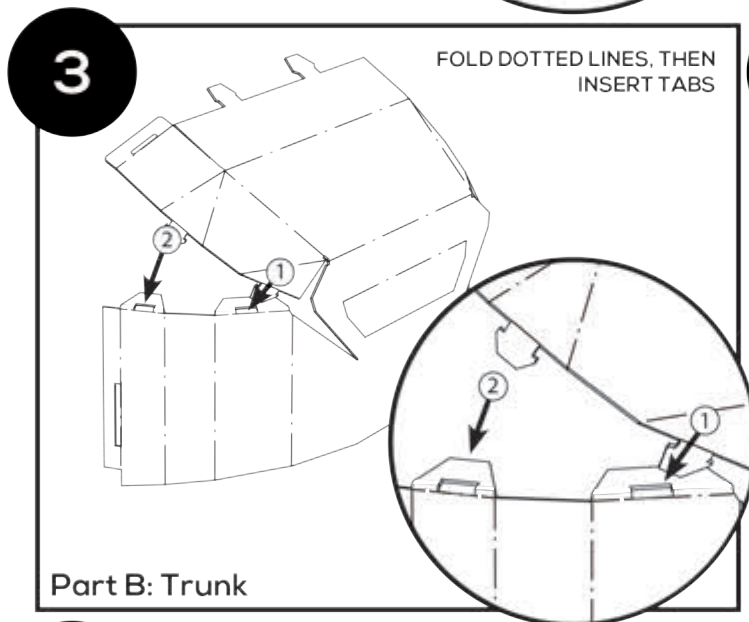
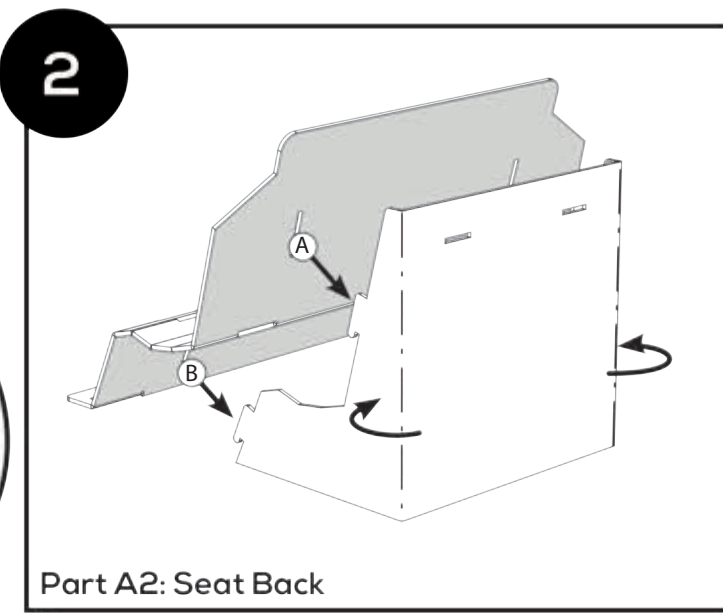
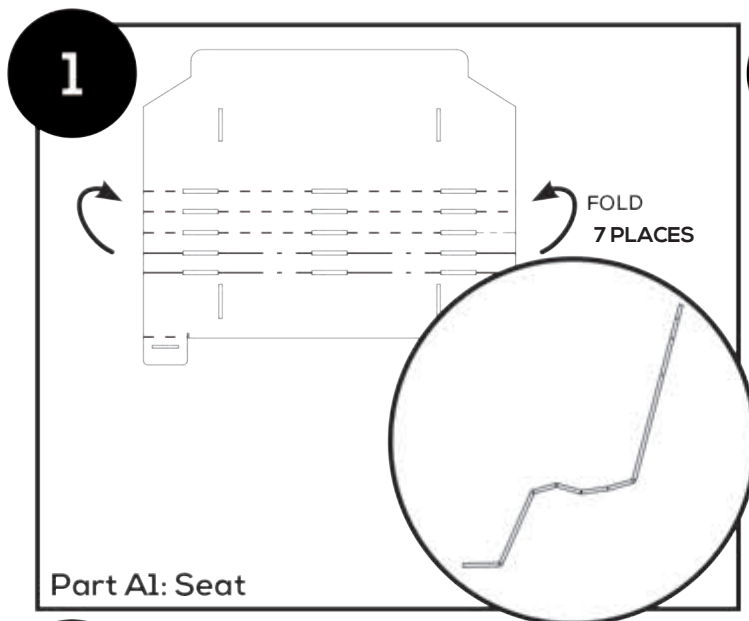

# PopUp Play™

7

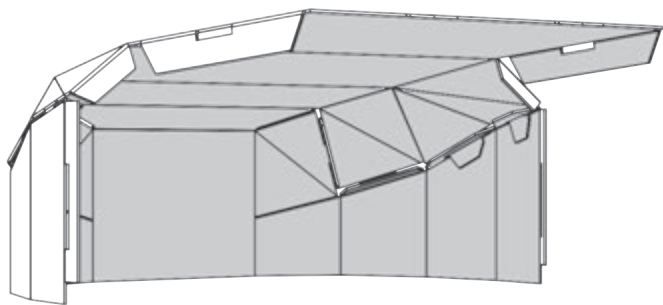

Assembled Hood

8

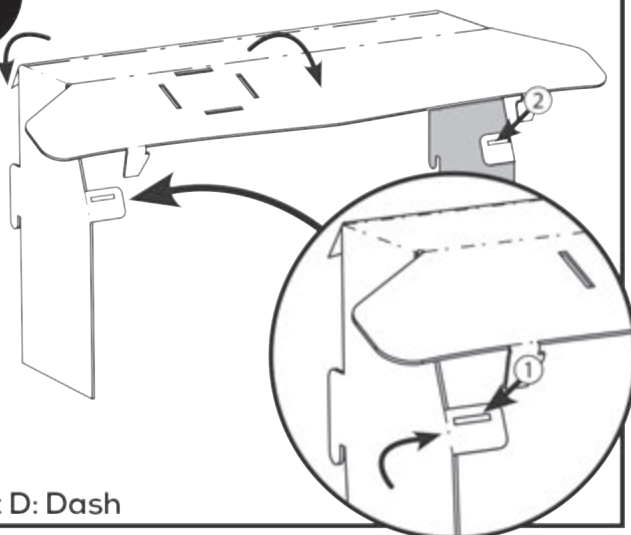

Part D: Dash

9

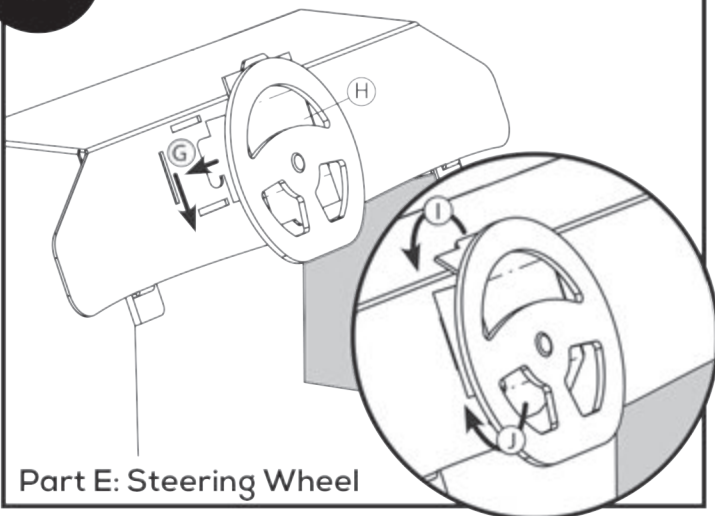

Part E: Steering Wheel

10

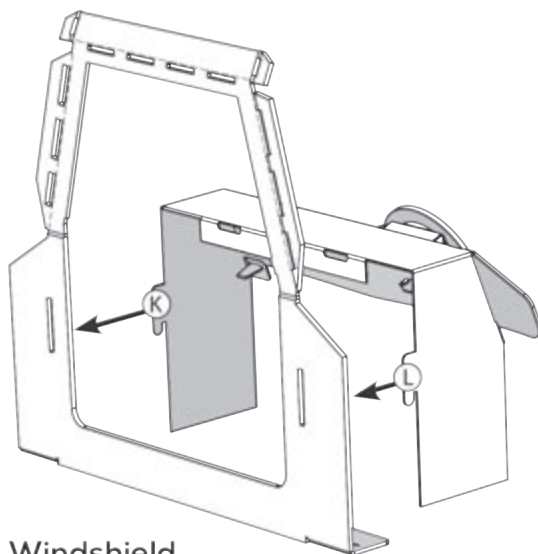

Part F: Windshield

11

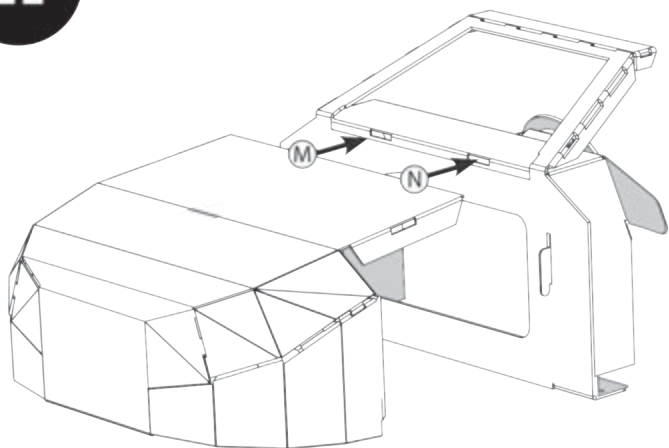

12

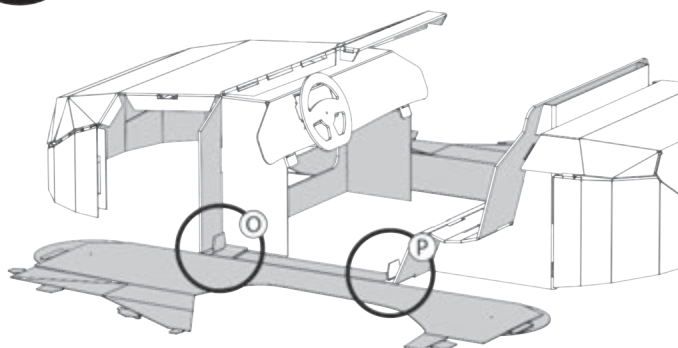

Part G1 & G2 : Sides

13

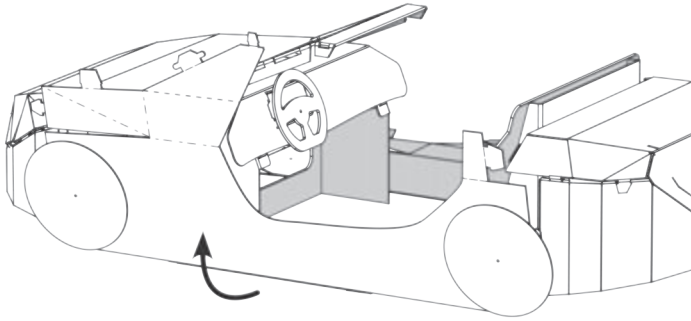

14

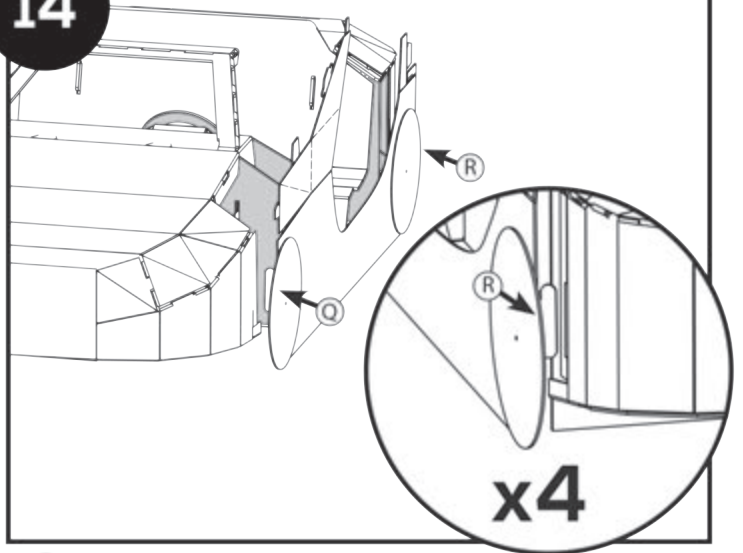

15

## WINGED TABS

Tuck in wings before inserting.  
Once inserted, untuck wings.

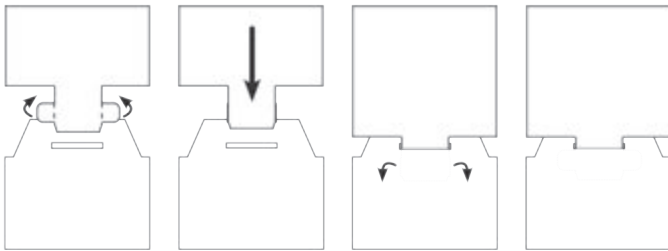

USE THIS STEP FOR TAB U & DD

16

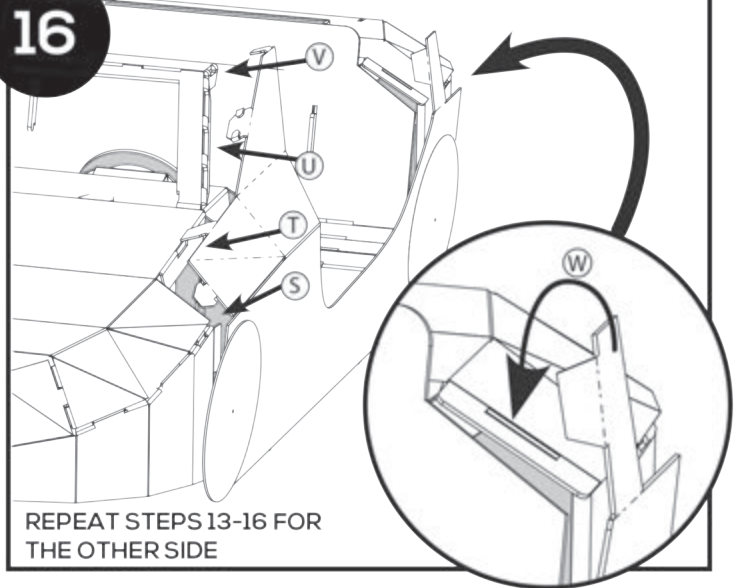

REPEAT STEPS 13-16 FOR  
THE OTHER SIDE

## OPTIONAL

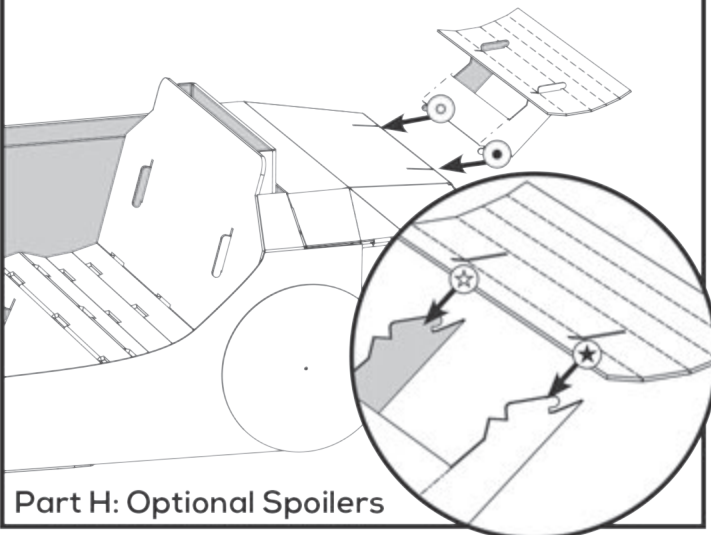

Part H: Optional Spoilers

## OPTIONAL

